

SEDIMENT TRAP KEY DESIGN ASPECTS					
MAP I.D. NUMBER	A	B	C	D	E
WEIR TYPE	Stone	Stone	Stone	Stone	Stone
DRAINAGE AREA (Ac.)	1.90	0.50	1.00	1.20	3.40
WET STORAGE REQ. (cf)	3420	900	1800	2160	6120
WET STORAGE PROV. (cf)	3615	1089	1830	2570	6273
DRY STORAGE REQ. (cf)	3420	900	1800	2160	6120
DRY STORAGE PROV. (cf)	4138	1350	1873	3180	6534
WEIR WIDTH (ft)	5.80'	3.00'	4.00'	4.40'	8.80'
DRY ST. HG. (ft)	2.75'	1.50'	2.00'	1.50'	2.00'
SEDIMENT STORAGE DEPTH (ft.)	3.25'	2.50'	3.00'	1.50'	2.50'
CLEANOUT ELEV. (ft.)	773.25	772.50	1000.00	1108.50	1006.00
EMBANKMENT ELEV. (ft.)	777.00	775.00	1003.00	1111.00	1009.00
TRAP BOTTOM ELEV. (ft.)	770.00	771.00	997.00	1107.00	1003.50

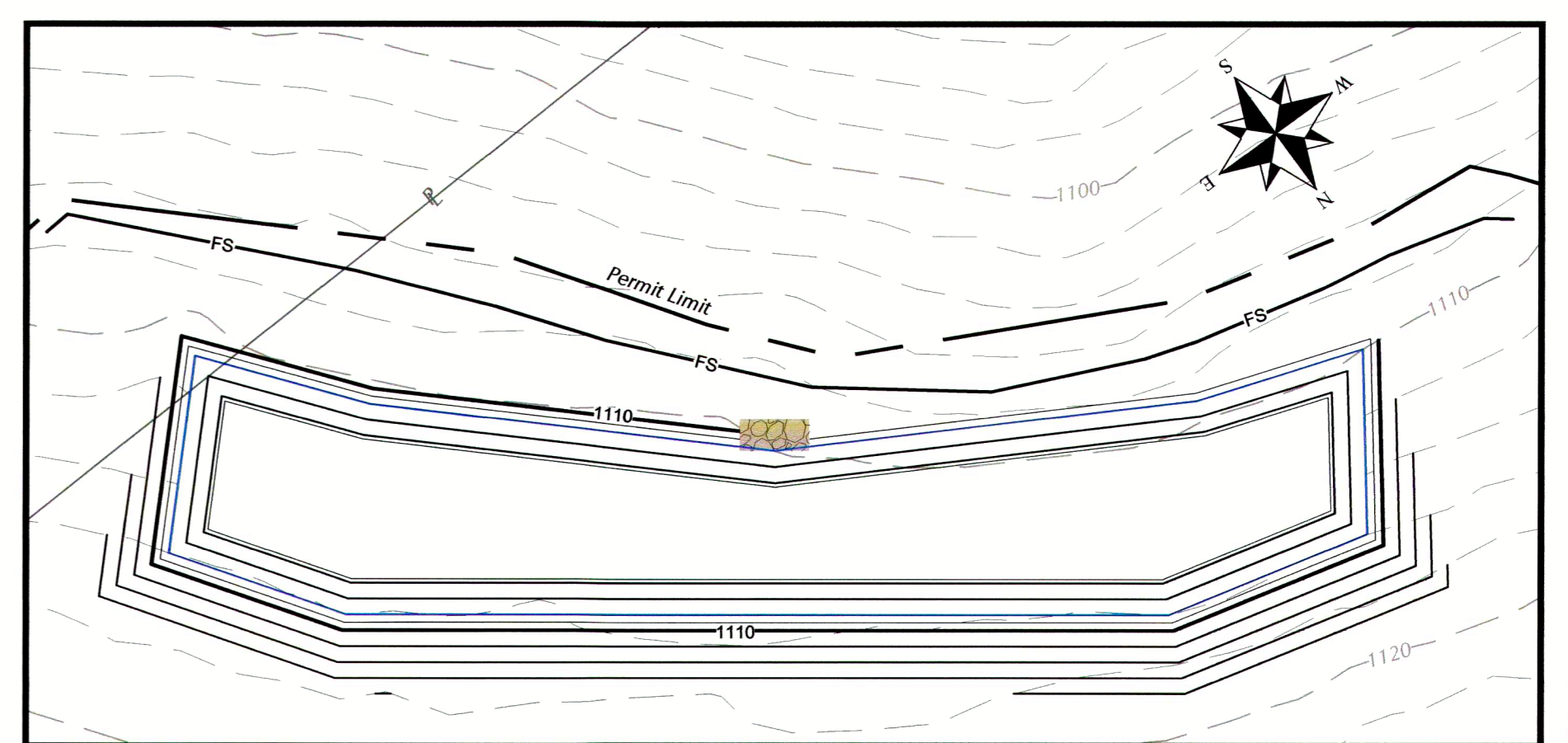

GC&P DEVELOPMENT, LLC.
 Located in the City of Wheeling, Wheeling District,
 Ohio County, West Virginia

Site Plan Views

HAMILTON
Associates, Inc.
 342 High St., Box 471
 Flushing, Ohio 43977
 PH: (740) 968-4947
 FAX: (740) 968-4225
 www.hamiltonandassoc.com

REVISIONS					DATE	BY	CHKD	COMM. NO.
No.	DATE	DESCRIPTION	BY	CHKD				

DRAWN BY: CHD
 CHECKED BY: CHD
 DATE: 04-07-2015
 COMM. NO.: 10081

SHEET **C2** 64